



SAFETY INSTRUCTIONS

- ⓘ Please read the instructions carefully before using.
- ⓘ Do not disassemble or refit the products.
- ⓘ Press touch sensor button properly.
- ⓘ Do not place the product in wet environment in case of reduction of mirror life.
- ⓘ Keep the mirror dry; moisture reduces the sensitivity of the product.
- ⓘ Turn off the power before cleaning. The surface of the mirror should be cleaned with glass cleaner; please make sure the mirror is completely dry before using.
- ⓘ Turn off the power and avoid direct sunlight if not used or stored for a long time. Far away from children's access.
- ⓘ Make sure that your charging device is adequate for the mirror voltage rating before using.
- ⓘ Do not approach or put the product into the fire in case of fire or explosion.
- ⓘ Stop using it immediately if abnormal condition occurs.

* We reserves the right of any modification of the product involving design and specification, all the materials here are for your reference only and are subject to the products you received. No further notice be given for any technical parameters changed.

WALL-MOUNTED LED BATHROOM MIRROR

OPERATION MANUAL

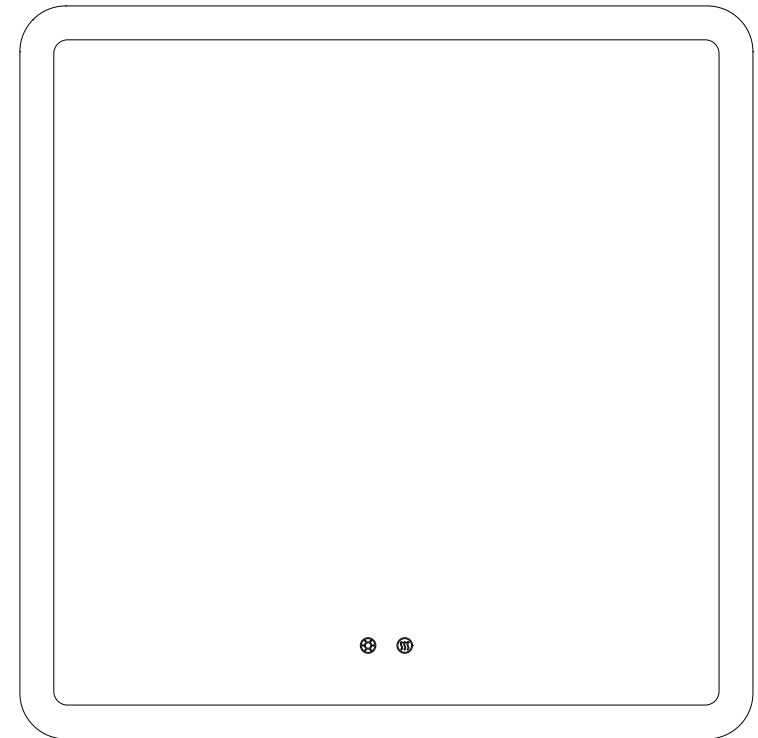

ILLUSTRATE

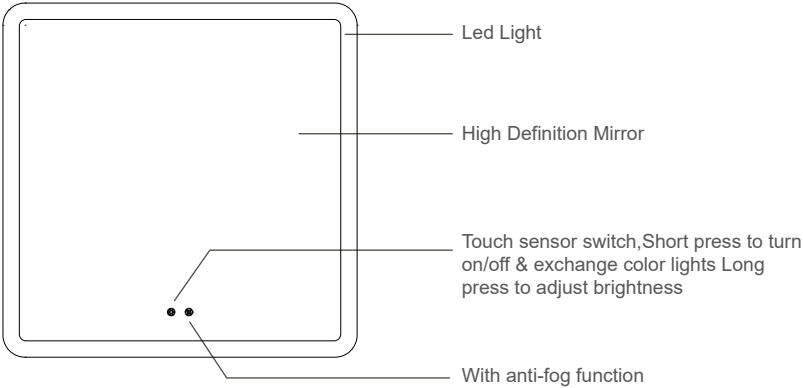

SPECIFICATIONS

[Product Name] Wall-mounted LED bathroom mirror

[Material] Iron frame + Glass

[LED Color Temperature] 3000K-6500K

[Power Supply] Power driver, AC 220V

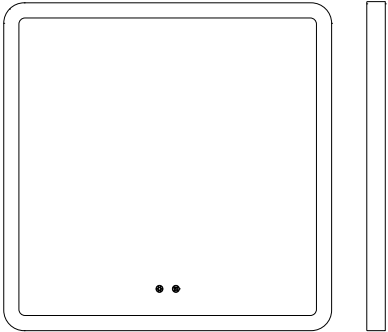

SPECIAL FEATURE

- 5mm Copper Free Mirror
- Free to switch between warm, natural and cool light
- Built-in touch sensor switch
- With anti-fog function
- Built-in power plug

PACKING LIST

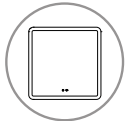

LED bathroom mirror



Screws 2pcs
Wall plugs 2pcs



Instruction Manual x 1pc

OPERATING INSTRUCTIONS

- (1) Please use standard plug to connect the power directly.
- (2) When the plug is connected to the power supply, the switch lights red and the power is on. press on/off switch to turn the light on, press anti-fog switch to open anti-fog function.
- (3) 100% brightness when turned on, long pressing to adjust the brightness.
- (4) Press the light switch to switch between warm, natural and cool light.
- (5) Press the power switch again to turn the light and anti-fog Off.
- (6) Unplug when it is no used.

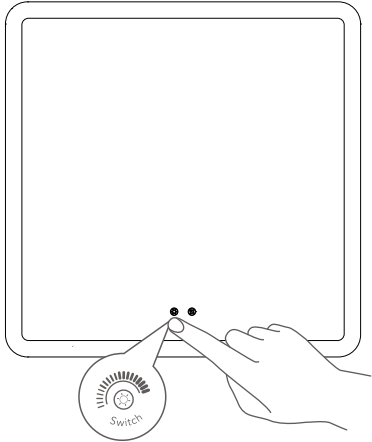

INSTALLATION METHOD

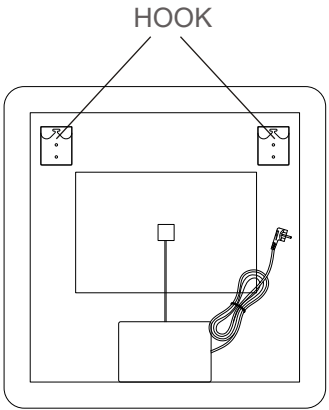

- ① Prepare tape measure, electric drill, hammer, screwdriver, pliers.
- ② Determine the appropriate height on a solid wall and draw two punctuations with a horizontal distance.
- ③ Drill holes in the punctuation, the depth of the hole is 3cm, knock the rubber plug into the hole, and then screw the screw, the screw is 2cm above the wall.
- ④ Pick up the product with both hands and hang it with the hook on the back of the product.